

## SECTION 1

## INSTALLATION INSTRUCTIONS RECEIVING AND HANDLING

### RECEIVING:



#### WARNING

**WARNING!** Use caution when unbanding the EOD Leveler. Keep hands clear of pinch points and wear appropriate safety attire - Glasses, Gloves, and Work Boots.

Check for possible damage or missing parts immediately upon receipt of unit. Note any damage on receiving papers.

Prepare any claims against carrier if necessary.

**NOTE:** Damage noticed after receipt must be reported to carrier within 15 days.

### HANDLING:



#### WARNING

**WARNING!** Use caution when lifting or moving the EOD Leveler. **DO NOT ATTEMPT** to lift without suitable hoisting equipment capable of lifting as much as 600 lbs.

Unit is easily handled for installation by hooking a heavy chain to each buttonhead rivet. (ED Series) or by hooking directly to the center plate. (BL Series)

## INSTALLATION INSTRUCTIONS INSTALLATION

### GENERAL INFORMATION:



#### WARNING

**DO NOT EXCEED DOCK LEVELER CAPACITY. OVER LOADING DOCK LEVELER COULD RESULT IN SERIOUS INJURY OR DEATH.**

Edge of Dock Levelers are designed to service trailers 5" above to 5" below dock level.

The dock levelers are shipped banded without tension on spring. Adjustment should be accomplished when installed.

Prior to installation, clean the dock face and dock area.

All prepunched holes are 13/16" diameter. Use 4" to 6" x 3/4" anchor bolts.



**WARNING:** Before you start to install the leveler, use proper safety signs and barriers to separate the work area from the remainder of the dock.



## SECTION 1

## INSTALLATION INSTRUCTIONS INSTALLATION

Illustration: 1

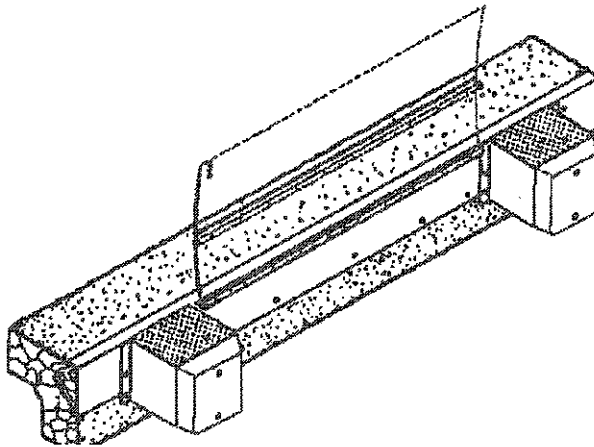

### WELD ON—NEW CONSTRUCTION

Use when dock edge vertical steel is 8" or wider. At dock edge, mark the center of chosen leveler location. Mark dock edge 33" either side of center (36" for 72" models; 39" for 78" models; 42" for 84" models).

Locate leveler with top of rear hinge flush with top of dock. This will place top of base plate approx. 1/4" below dock surface.

Tack weld ends of base plate to dock face steel, the top edge of base plate being 1/4" below dock. Tack weld both bump blocks at left and right ends of leveler allowing 1/4" space for weld between base plate ends and bump block.

Continuous weld bump blocks and base plate along top and all vertical edges while holding leveler firmly against dock. Disregard prepunched holes.

Illustration: 2

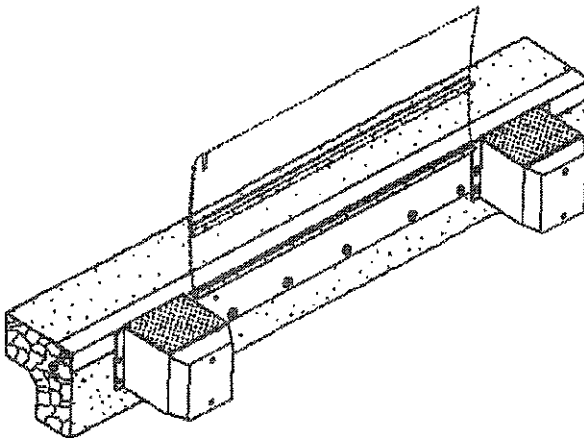

### WELD ON/BOLT ON—EXISTING CONSTRUCTION

Use when dock edge steel is securely anchored, but not adequate for weld-on method.

Complete all steps of instruction under "Weld On—New Construction."

Bolt leveler and bump blocks to dock face using all 13/16" prepunched holes furnished.

## SECTION 1

## INSTALLATION INSTRUCTIONS INSTALLATION

Illustration: 3

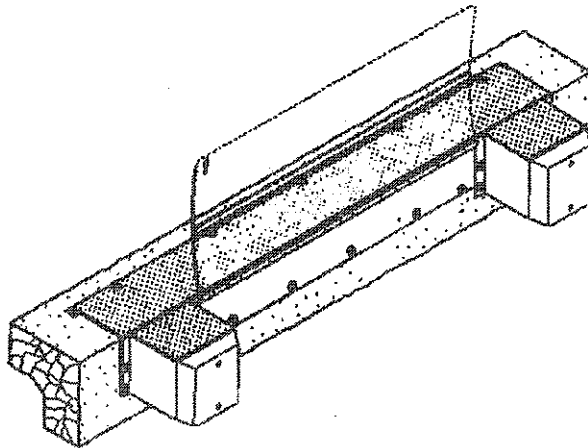

All anchor bolts must be installed in accordance with the manufacturer's instruction. Improper installation may result in serious personal injury or death.

**DO NOT** install anchor bolts in cracks of expansion joints in concrete. Installation in cracks or expansion joints may cause the anchors to come loose and pull out. Use of improperly installed anchor bolts may result in serious personal injury and/or death.

### BOLT ON + APPROACH PLATE — EXISTING CONSTRUCTION

Use when dock edge has no steel, or steel is poorly anchored, and dock face is adequate for bolting. Mark and drill holes for dock leveler centered 6-1/4" below dock edge; base plate to be raised 1/8" above dock edge for welding to approach plate. Install two (2) anchor bolts in end holes, position leveler on bolts and partially tighten nuts to hold leveler secure.

Place approach plate in position on floor, front edge being 1/8" behind base plate. Mark floor along rear edge of approach plate.

Slide plate forward 2", tack weld to leveler and use as a guide for cutting groove in floor along entire width (long dimension) of approach plate. Groove to be 2" wide and 1/8" deeper than thickness of approach plate.

Break plate loose from leveler. Position approach plate in groove and tack weld to leveler base plate. Drill holes in floor using plate holes as guide. Install anchor bolts in plate (See General Information page 1-1). Weld and grind bolt heads to approach plate to a smooth dome shape. Continuous weld approach plate to top of base plate. Complete bolting phase of unit.

### NOTE:

All anchor bolts lengths must suit local codes and conditions. Type and depth of concrete will determine type and length of anchor bolts required.

## SECTION 1

## INSTALLATION INSTRUCTIONS INSTALLATION

Illustration: 4

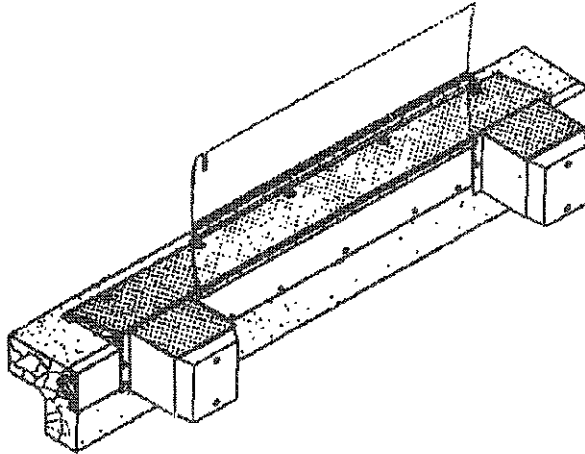

### WELD ON AND RAISE APPROACH PLATE

Use when dock edge is sound but height is less than adequate (bolting may also be required). At dock edge, mark the center of chosen leveler location. Mark dock edge 33" either side of center (36" for 72" models; 39" for 78" models; 42" for 84" models).

Raise leveler and bump blocks to desired height (3" max.), and weld back of base plate to dock edge steel. Tack weld both bump blocks at left and right ends of leveler allowing 1/4" space for weld between base plate ends and bump block.

Cut groove in floor, position approach plate at top edge of base plate and tack weld to unit and bump blocks. (See Illustration 3 for details.)

Complete bolting phase of installation, then continuous weld all points of contact between leveler, dock steel and approach plate.

Illustration: 5

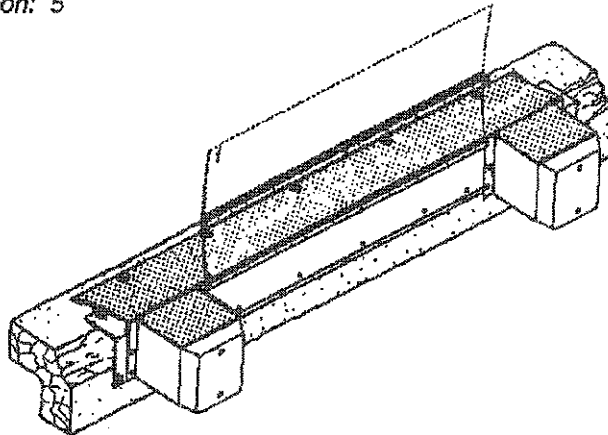

### FORMED ANGLE-WELD ON—RAISED APPROACH PLATE

Use when dock edge is badly crumbled and dock edge is slightly low.

Unit must be raised approximately 2" in this application!

Position formed angle at desired location, mark holes, remove angle, drill holes and install angle. Install unit and approach plate according to methods described for "Existing Construction" (See Illustrations 3 & 4).

## SECTION 1

## INSTALLATION INSTRUCTIONS INSTALLATION

### BARLIFT MODELS

After installation of EOD and Bumpers is completed, remove bolt from lifting bar, insert bar into bracket (handle facing forward) and reattach bolt.

## SECTION 2

## MAINTENANCE

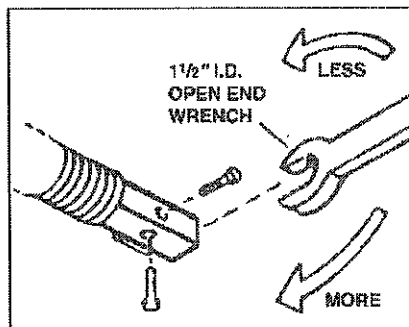

### adjusting tension on ramp

Units are shipped with no tension on ramp. After dock leveler is installed, adjust tension as follows:

1. Loosen the two set screws in spring winding assembly.
2. Place 1-1/2" wrench on square tubing and rotate tubing toward you approximately 1/4 turn. Hold tube in this position and tighten set screws.
3. Test the unit for lifting ease. Repeat steps 1 and 2 as necessary to provide easy lifting.



### WARNING

**WARNING! DO NOT** allow lip and ramp to fall free. Allowing dock leveler to fall free could result in dock leveler coming free from dock or damaging linkage resulting in property damage, serious injury and/or death.

### LUBRICATION PROCEDURE

For proper operation of your dock leveler, cleaning and lubrication should be performed every 90 days. Lubricate prior to attempting to adjust your leveler.

## SECTION 3

## OPERATING INSTRUCTIONS EDGE OF DOCK

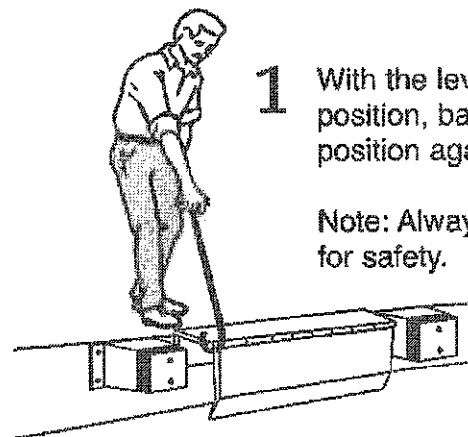

- 1** With the leveler in the stored position, back the truck into position against the bumpers.

Note: Always chock the wheels for safety.

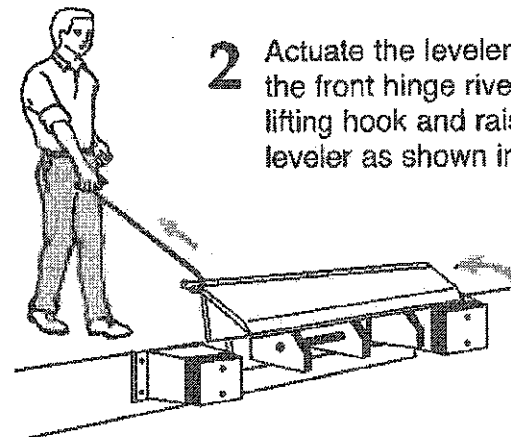

- 2** Actuate the leveler by hooking the front hinge rivet with the lifting hook and raising the leveler as shown in Fig. 2.

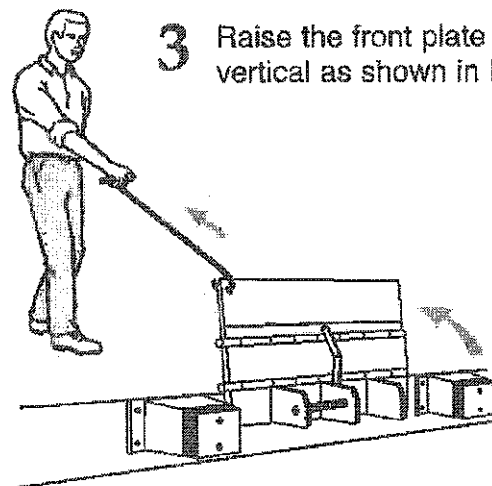

- 3** Raise the front plate (lip) to vertical as shown in Fig. 3.

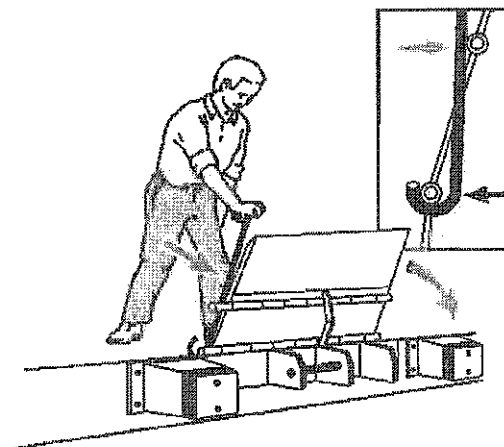

- 4** Place the lifting hook on the rear hinge pin and behind the front hinge rivet and push the leveler into the truck as shown in Fig. 4.

- 5** When the truck departs the leveler automatically returns to the stored position.

## SECTION 3

## OPERATING INSTRUCTIONS BAR LIFT EDGE OF DOCK

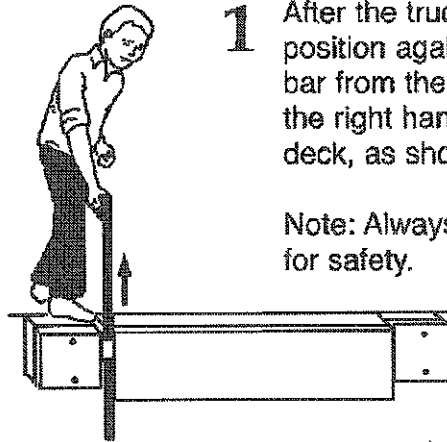

- 1** After the truck has backed into position against the bumpers, lift bar from the stored position on the right hand side below the deck, as shown in Fig. 1.

Note: Always chock the wheels for safety.

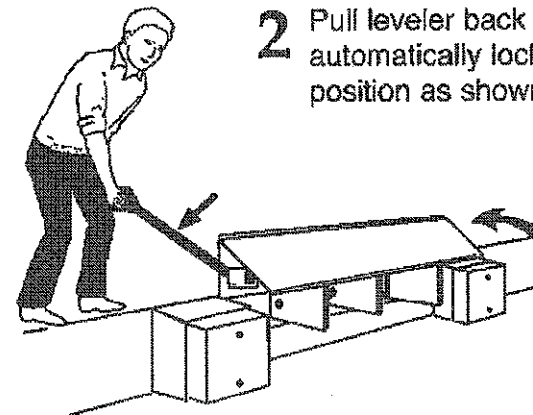

- 2** Pull leveler back until it automatically locks in raised position as shown in Fig. 2.

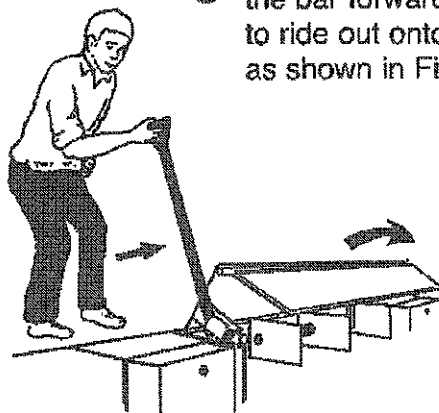

- 3** Using the bar as a lever, push the bar forward, allowing the lip to ride out onto the truck bed, as shown in Fig. 3.

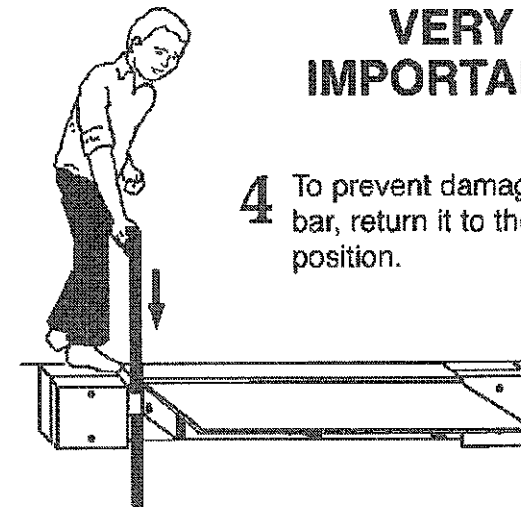

**VERY  
IMPORTANT!**

- 4** To prevent damage to the bar, return it to the stored position.

## SECTION 4

PARTS LISTS  
EDGE OF DOCK

Item #	Model Description	ED66M	ED72M	ED66M17	ED72M17	ED66MH	ED72MH	PO66M	PO72M
1	Lip Plate Assy.	154	182	175	297	179	0724	185	1767
2	Lip Hinge Pin	115	189	115	189	115	189	115	189
3	Rivet (2 ea. for ea. pin)	188	188	188	188	188	188	188	188
4	Center Plate Assy.	153	183	153	183	180	737	186	1768
5	Base Plate Assy.	151	184	151	184	151	184	151	184
6	Base Hinge Pin	116	190	116	189	116	189	116	189
7	Torsion Spring	111A	111A	111A	111A	111A	111A	111A	111A
8	Winding Assy. — Assy.								
9	Torsion Arm & Linkage Assy.	149	149	149	149	149	149	149	149
10	Gusset w/Bearing	156	156	156	156	156	156	156	156
11	Bearing, Torsion Arm	128	128	128	128	128	128	128	128
12	Gusset w/Retainer	157	157	157	157	157	157	157	157
13	Gusset	107	107	107	107	107	107	107	107
14	Lip Tab	122	122	122	122	122	122	815	815
15	Lip Linkage Arms (2 ea. req.)	123	123	123	123	123	123	814	814
16	Linkage Pins (2 Ea. req.)	193	193	193	193	193	193	193	193
17	Pin Keys (2 ea. req.)	235	235	235	235	235	235	235	235
18	Molded Cord Rubber (4x10x13) - 2 Hole	9243	9243	9243	9243	9243	9243	9243	9243
19	Bump Block Steel w/Cover	9270	9270	9270	9270	9270	9270	9270	9270
20	Bump Block Assembly	1867	1867	1867	1867	1867	1867	1867	1867
21	Bump Blk Assy. (opt. 18")	208	208	208	208	208	208	208	208
		141	141	141	141	141	141	141	141
22	Adapter Kit Assy. ED66M/ED72M	192	192	192	192	192	192	192	192
23	Molded Cord Rubber (4x12x13) - 4 Hole	137	137	137	137	137	137	137	137
24	Bump Block Steel w/Cover	138	138	138	138	138	138	138	138
For 4 Hole Rubber									



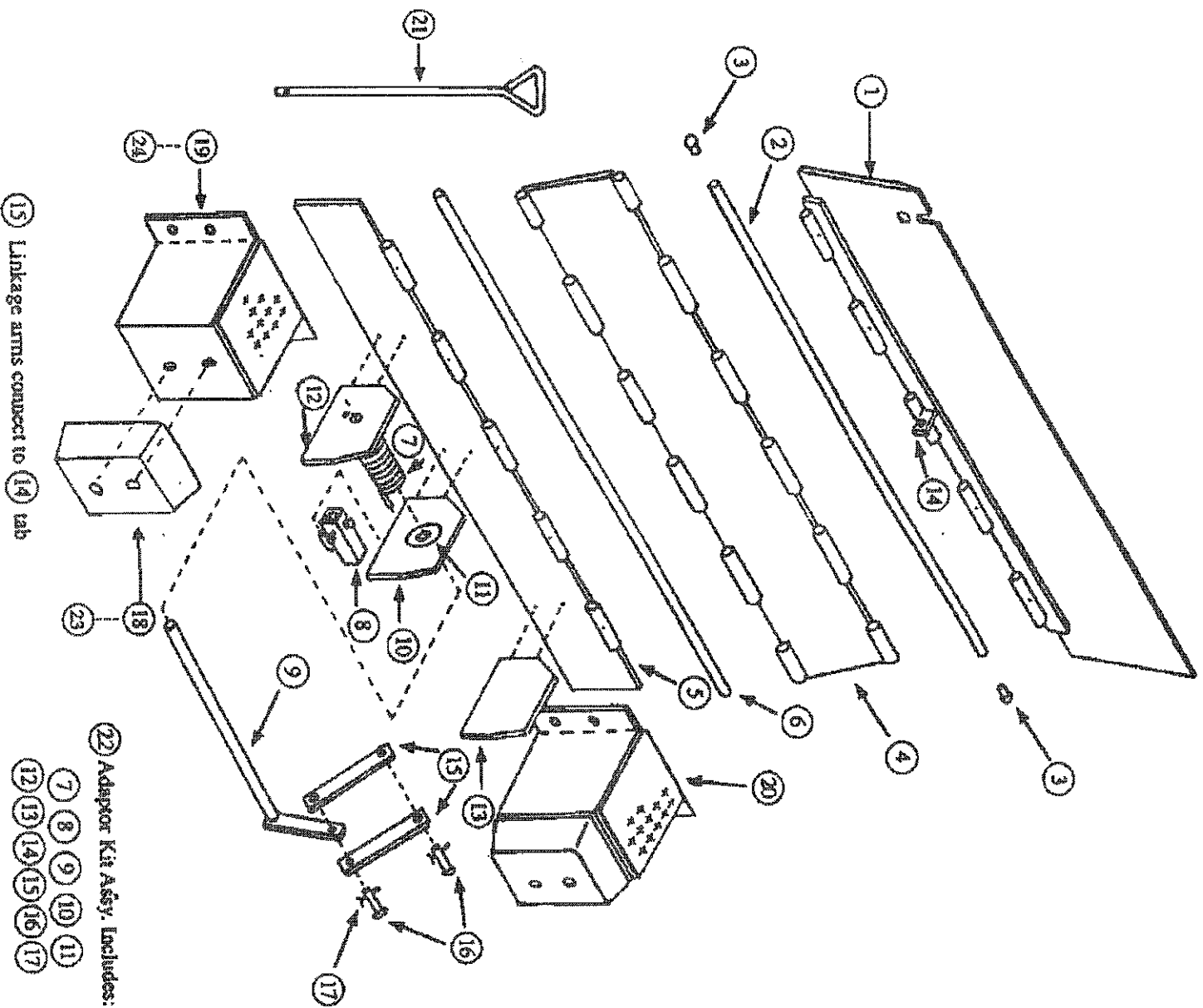

## SECTION 4

PARTS LIST  
BAR LIFT EDGE OF DOCK

Item #	Model Description	BL66	BL72	BL6617	BL7217	BL66H	BL72H	BL78	BL84
1	Lip Plate Assy.	154	182	175	297	179	724	1761	1764
2	Lip Hinge Pin	115	189	115	189	115	189	1462	481
3	Rivet (2 ea. for ea. pin)	188	188	188	188	188	188	188	188
4	Center Plate Assy.	153	183	153	183	180	737	1762	1765
5	Base Plate Assy.	1513	184	151	184	151	184	1763	1766
6	Base Hinge Pin	116	190	116	189	116	189	1463	481
7	Torsion Spring	111A	111A	111A	111A	111A	111A	111A	111A
8	Winding Assy. Assy.								
9	Torsion Arm & Linkage Assy.	149	149	149	149	149	149	149	149
10	Gusset w/Bearing	156	156	156	156	156	156	156	156
11	Bearing, Torsion Arm	128	128	128	128	128	128	128	128
12	Gusset w/Retainer	157	157	157	157	157	157	157	157
13	Gusset	107	107	107	107	107	107	107	107
14	Lip Tab	122	122	122	122	122	122	122	122
15	Lip Linkage Arms (2 ea. req.)	123	123	123	123	123	123	123	123
16	Linkage Pins (2 Ea. req.)	193	193	193	193	193	193	193	193
17	Pin Keys (3 ea. req.)	235	235	235	235	235	235	235	235
18	Molded Cord Rubber (4x10x13)	9243	9243	9243	9243	9243	9243	9243	9243
19	Bump Block Steel w/Cover - 2 Hole	9270	9270	9270	9270	9270	9270	9270	9270
20	Bump Block Assembly	1867	1867	1867	1867	1867	1867	1867	1867
	Bump Blk. Assy. (opt. 18")	208	208	208	208	208	208	208	208
21	Bar Lift Handle Assembly		1726	1726	1726	1726	1726	1726	1726
22	Bar Lift Holder Assembly		1725	1725	1725	1725	1725	1725	1725
23	Lip Linkage Tabs (2 ea. req.)	445	445	445	445	445	445	445	445
24	Lip Kickout Bar	446R2	446R2	446R2	446R2	446R2	446R2	446R2	446R2
25	Lip Release Tab	1405	1405	1405	1405	1405	1405	1405	1405
26	Lip Stop Tab	503	503	503	503	503	503	503	503
27	Lip Kickout Pin	251	251	251	251	251	251	251	251
	Bar Lift Conversion Kit w/Push Over	[—No. 453 & 1727, All Models—]							
28	Kick Out Bar Guide	1017	1017	1017	1017	1017	1017	1017	1017
29	Molded Cord Rubber (4x12x13) - 4 Hole	137	137	137	137	137	137	137	137
30	Bump Block Steel w/Cover	139	139	139	139	139	139	139	139
	For 4 Hole Rubber								

Dock Equipment - Edge of Dock Mechanical Leveler

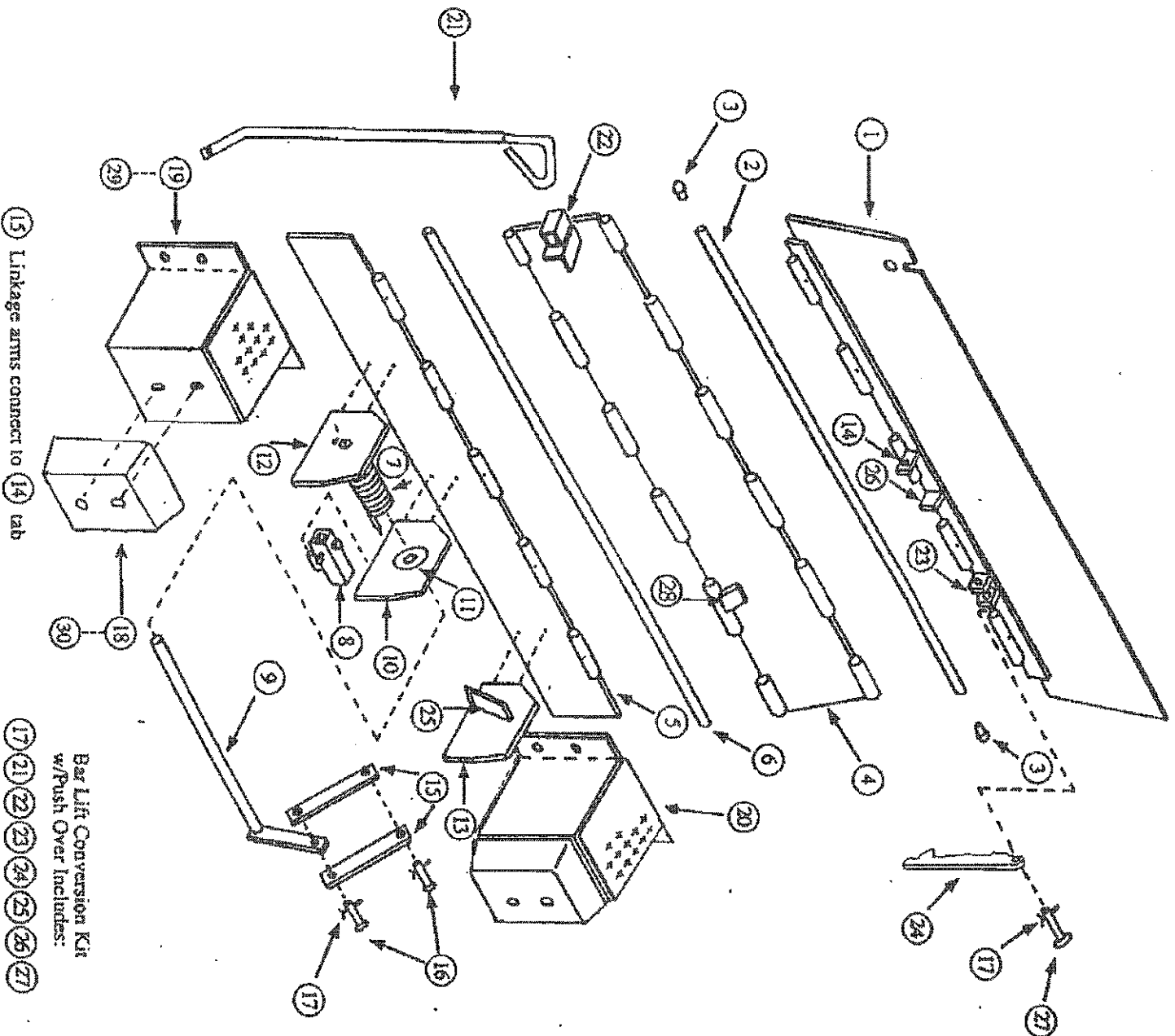

## SECTION 4

## PARTS LIST & DIAGRAM ADAPTOR KIT ASSEMBLY – ED66M

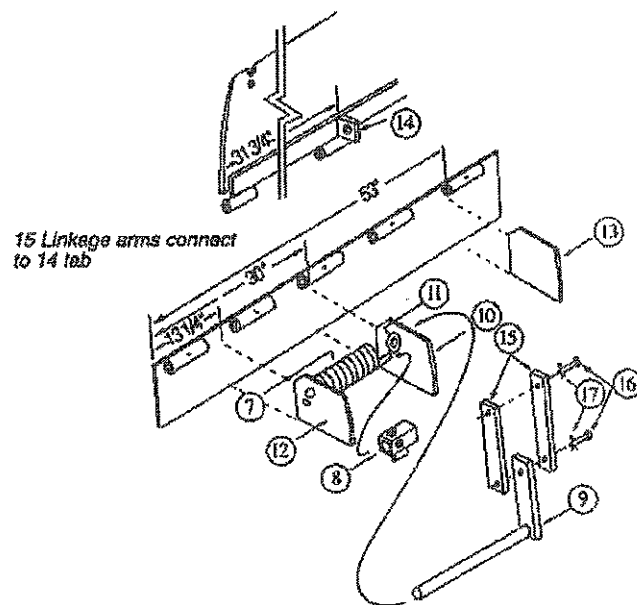

### ADAPTOR KIT ASSEMBLY — ED66M

ED66M Kit, Part #192, consists of the following:

ITEM	DESCRIPTION
7	Torsion Spring
8	Spring winding tube assy.
9	Torsion arm & linkage assy.
10	Gusset with bearing
11	Bearing, torsion arm
12	Gusset with retainer
13	Gusset
14	Lip linkage tab
15	Lip linkage arms (2 ea. req.)
16	Linkage pins (2 ea. req.)
17	Cotter Keys (2 ea. req.)

